

Bloomfield's Blueprint

*Returning to teaching &
learning for the 2020-2021
school year*



October 8, 2020



Part One
COVID Data Update



Reporting Period: September 23- October 6

Reporting period: September 23 – October 6			
METRIC	RESULT	Trend	DEFINITION
Total “Confirmed and Probable” COVID-19 Cases Reported in Oakland County	999	→	“Confirmed”: laboratory-confirmed positive molecular viral test “Probable”: rapid-antigen positive viral test
Cases/Day per Million Population 7-Day Average 14-Day Average	41 59	→	Average number of cases per day per million population over the given timeframe
14-Day Average Daily Case Counts	71	→	The average number of cases per day reported over the last 14 days of the reporting period
14-Day Average Daily Death Counts	0.07	↓	The average number of deaths per day reported over the last 14 days of the reporting period
14-Day Average Tests Per Day	3242	→	The average number of diagnostic tests administered to Oakland residents over the last 14 days of the reporting period
Percentage of Cases Hospitalized in the Last 14 Days	3.10%	→	The percentage of cases (confirmed and probable) that reported being hospitalized over the last 14 days of the reporting period
Percent Positivity (7 days)	3.17%	→	Percentage of reported positive tests over the last 7 days (September 30 – October 6)
Percent Positivity (28 days)	3.88%	↓	Percentage of reported positive tests over the last 28 days (September 9 – October 6)
Healthcare Capacity Strength	STRONG	→	Assessment of bed availability and hospital capacity
Testing, Tracing, Containment Infrastructure	STRONG	→	Assessment of testing availability and OCHD contact tracing capability
County Level Risk Determination	C	→	County level risk determination based on state guidance. Local epidemiology is also a factor in school and district-specific decision making

Total Oakland County Cases Reported by Age Group					
Age Group	Total Cases	Trend	Age Group	Total Cases	Trend
0-4	14	→	50-59	161	↗
5-9	20	↘	60-69	104	↗
10-13	27	↘	70-79	54	↗
14-18	63	↘	80-89	18	→
19-29	209	↘	90+	11	→
30-39	155	→	Unknown	2	
40-49	161	↗			

The number of reported cases remained stable from last week. The 7-day average number of cases increased due to an unexpectedly low 7-day case rate last reporting period. There was a shift in the ages of the cases this reporting period, with cases in school aged children decreasing slightly and cases in the 40-49 age group increasing by 40 this reporting period.

On the homepage
www.bloomfield.org
& updated daily

County Dashboard: Oakland County

New Cases per 100K Data

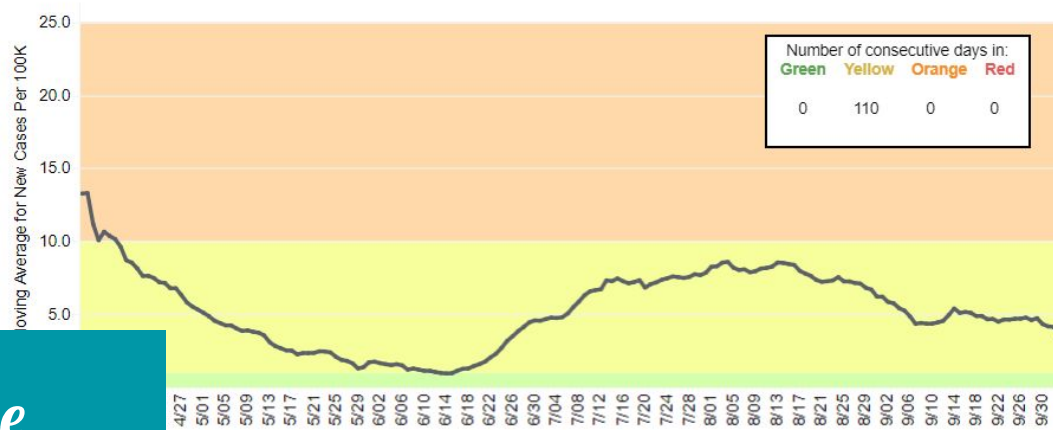

Data for 10/3/2020:
 New Cases per 100K: 1.19
 Percent Positive: 4.16%

County

Oakland County

Show Data From:

4/9/2020 10/3/2020



New Cases Moving Avera...

Percent Positive Moving ...

Data Source:

<https://www.michigan.gov/coronavirus>

Moving average is based on previous 7 days, with a lag time of 3-days for data accuracy.

Reference lines are shown for risk of outbreak levels:

Red: >25 cases/100K
 >10% positivity

Orange: 10<25 cases/100K
 5<10% positivity

Yellow: 1<10 cases/100K
 3<5% positivity

Green: <1 cases/100K
 <3% positivity



Developed in collaboration with Bloomfield Hills School District and Munetrix

Percent Positive Data

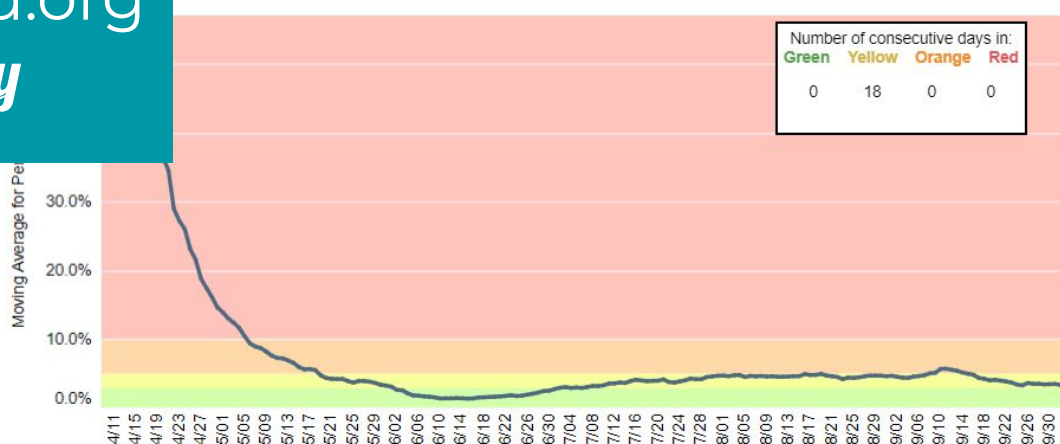

Recently, researchers at Brown University, working with school administrators, released their first set of data from a new [National COVID-19 School Response Data Dashboard](#), created to track coronavirus cases. It found low levels of infection among students and teachers and indicated that school transmission is much lower than anticipated.

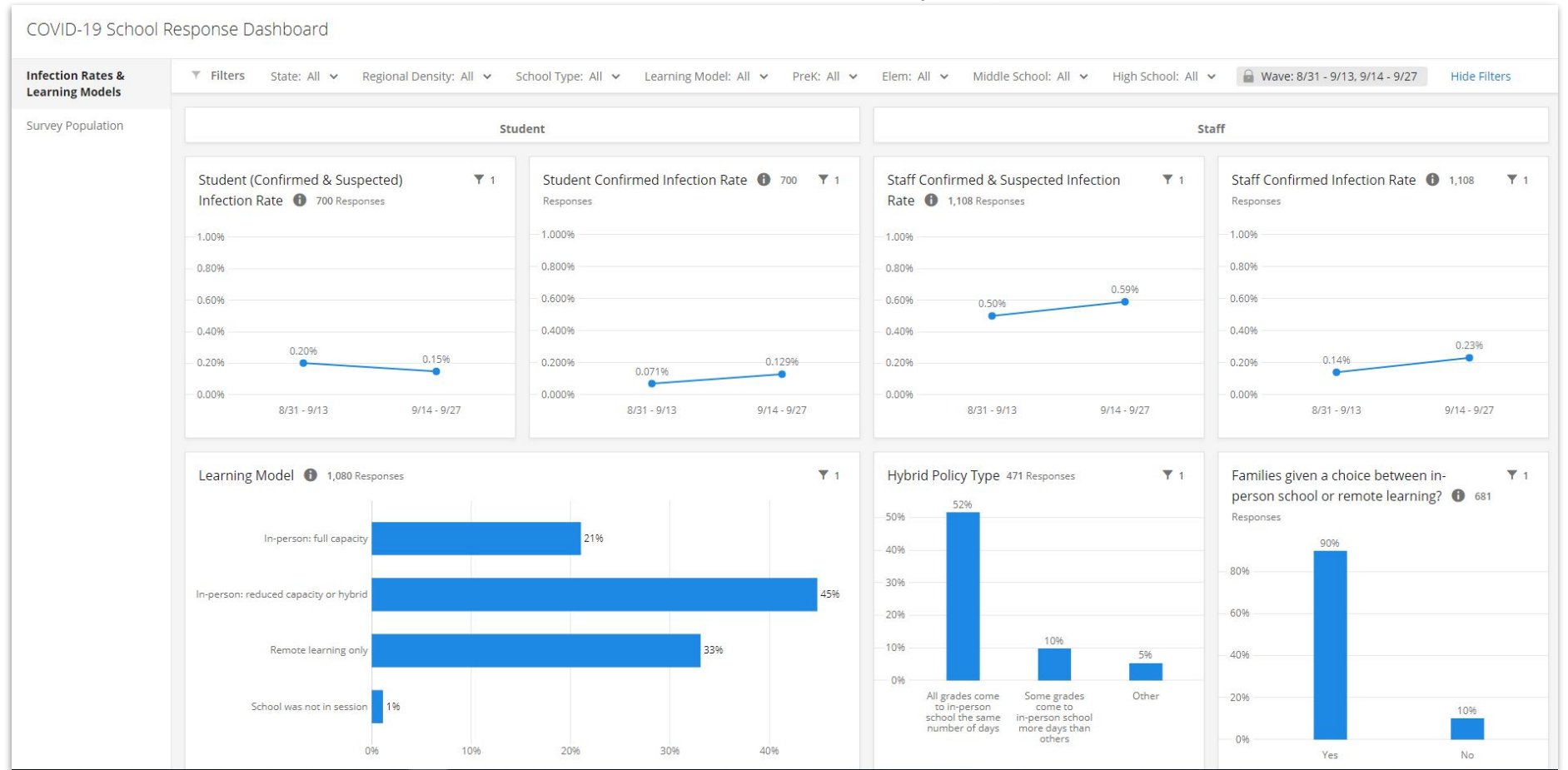

End of COVID Data Update

Part Two

Return to School Buildings



Conant, Eastover, Lone Pine, Way

Through which challenge are we persevering?

- Teaching sounds and annunciation, including some speech therapy
- Students learning the affect and nuances of conversation
- Ancillary staff relationships /interaction with students
- School days are more robotic/rigid
 - Elementary culture of precovid allowances (parent involvement, student led activities)
- Collaborative work
- At home work time - accountability
- Corrective/Immediate Feedback/Communication
- Workload Balance
- Stamina of students and teachers with the schedule
- Tech challenges

Conant, Eastover, Lone Pine, Way

What is going well:

- Students navigating technology (Zoom, Fastbridge, Flipgrid, Google Classroom)
- Students have adapted incredibly well to new norms of conduct (masks, distancing, etc)
- Content focus and balance feels appropriate / Students have risen to the occasion to condensed learning
- Independence, responsibility, general executive functioning skills are being explicitly addressed
- Renewed focus on social emotional learning
- Small class sizes - how well peers know each other
- Students are open about their feelings during SEL check ins
- Smiling faces, students settling into routines well and instructional time
- Families have been supportive
- Staff have a strong grasp of student abilities, personalities and needs



Bloomfield Virtual





Wing Lake





Wing Lake



*We
are so
happy
to be
back!*



→ 
Going Back to School

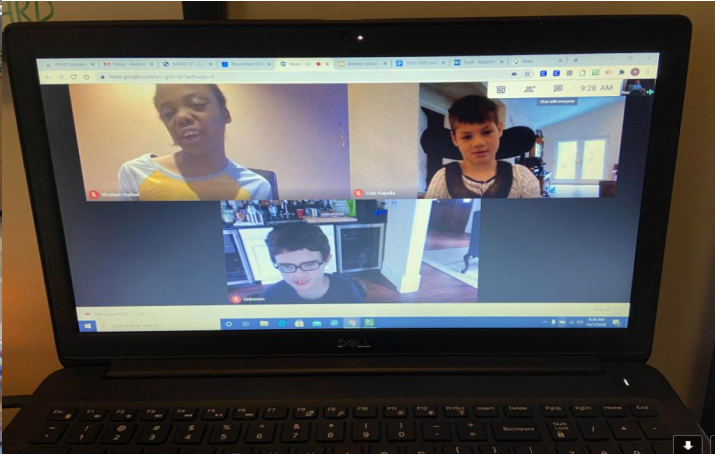



Middle School

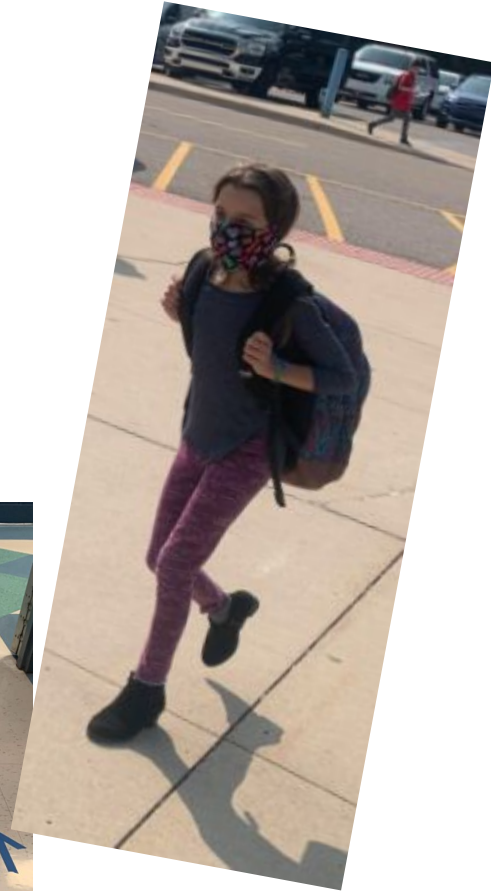
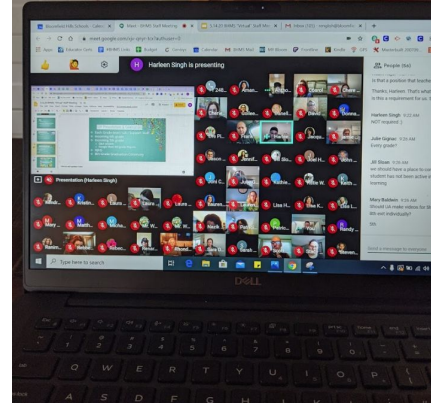



BHMS



EHMS



WHMS

Middle School

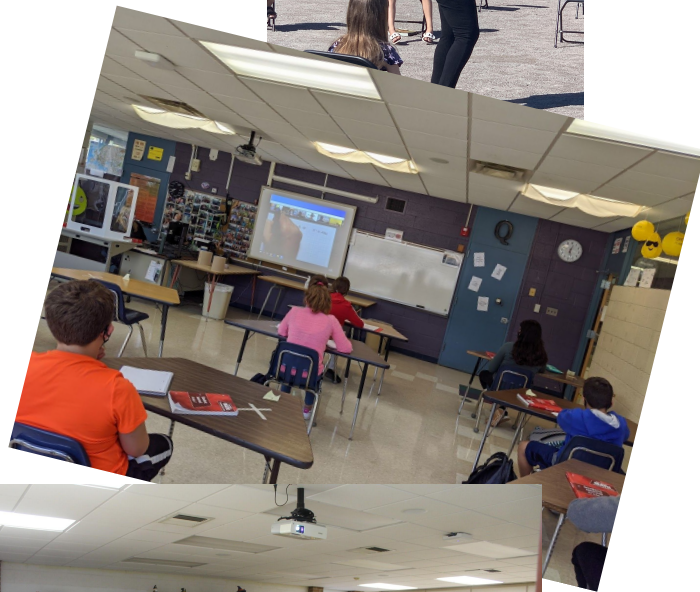
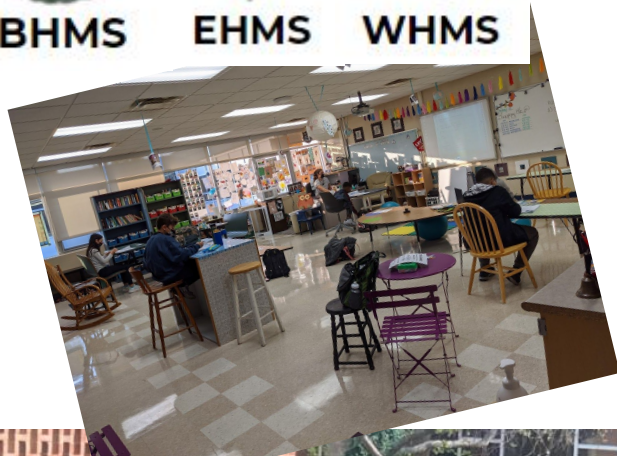

International Academy



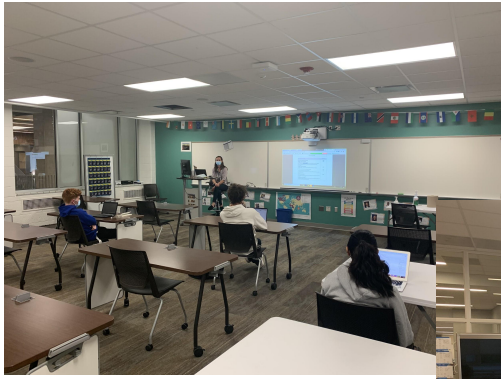

BHHS

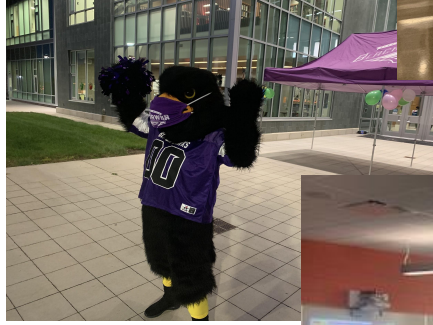
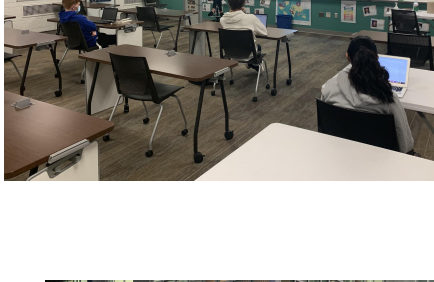



Bowers Academy



Developing Professional Learning

A Multipronged Approach to Instructional Support





Launching the Year



Self-Directed Resources

Self-guided courses provided for Google Classroom, Canvas, and Fundamentals of Teaching Online.

Curated library of tech and learning resources on our internal IT website.



Collaborative Learning & Problem Solving

Teacher and building leader initiated group meetings to share strategies found to be useful.

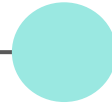

Facilitated Conversations

Focused conversations on instructional design elements

Looking at models of blended learning

Formative assessment approaches in virtual learning

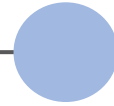

Professional Learning Sessions

Provided live webinars on Fundamentals of Teaching Online, Remote Teaching in 2020, and Trauma Informed Practices.



Examples

Collaboration Spaces

Physical Education K-5

Class code: g7abwll

Meet link: <https://meet.google.com/foqulgr>

Bloomfield Hills

K-5 PE

Select theme
Upload photo

Upcoming
No work due soon
View all

Share something with your class...

Lindsay Tocco
Oct 3
<https://www.floppy.org/>
Saving for later. This site is awesome!

Add class comment...

Taylor Tollafeld posted a new material: Fire Safety Lesson
Oct 2

Lindsay Tocco
Sep 30
Had to modify the lesson...the exercises were too hard and no one could hear the video! Thankfully my first class was patient and helped me along LOL. New lesson should be good for 1st-4th

PE Lesson-Spell your na...
Google Slides

Live Webinars

FALL 2020

FUNDAMENTALS OF TEACHING ONLINE

INFORMATION EXCHANGE

Once good access habits have been established and your students are starting to come together as a community, more consistent information exchanges can occur. Use Google Classroom and other online resources to provide materials and instruction to your students. Keep the information sized in manageable chunks based on the age and skills of your students.

Self-Guided Learning

Google Classroom

0% COMPLETE

ORIENTATION

- Welcome Video - Kimberly Hempton
- Navigating the Course

GETTING STARTED WITH GOOGLE CLASSROOM - THE BASICS

- What is Google Classroom?
- Accessing Google Classroom

Lesson 10 of 23

Creating Assignments

When you create an assignment, you can post it immediately, save a draft, or schedule it to post at a later date. After students complete and turn in

BHHS Staff Hub

Home
Modules
Discussions
Conferences

BHHS
Black Hawks

Moving Forward



Providing building based leaders and teacher leaders with guided conversation tools that focus on instructional design decisions.

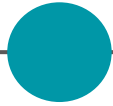

Supporting multiple instructional approaches to meet the needs of students in-person, hybrid, and/or virtually.

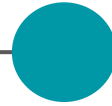

Creating collaborative digital spaces:

Grade level Google Classrooms

Shared “sandbox” Canvas courses

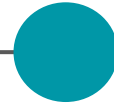

Using pre-established meeting structures for embedded professional learning.

Designing bite-sized learning that can sit within a 30-45 minute meeting (drop-in live learning sessions and open office hours).

Health & Wellness Update

- Return to F2F Instruction has been successful in this initial month
- Everyone appears to be happy to be back in school, and from what we've seen, both students and staff are following the appropriate protocols and guidelines
- We continue to update and adapt our processes based on data driven evidence and underlying guidance from the CDC and the OCHD, most recently our internal Possible/Confirmed COVID-19 Reporting Form.
- In collaboration with our Communication Team, we are actively formulating a new pre-recorded message that will be played district wide for parents utilizing the Attendance Hotline for reporting illness or other non-health related school absences



Part Three
Bond Update



Series 1 Bond Issuance Results



Pre-election Schedule/ Board Approved Parameters:	Pre-election/ Pre-sale Schedule:	Final Figures:	Difference:
Bond amount of not to exceed \$ 94,050,000	\$ 94,050,000	\$ 94,045,061	(\$ 4,939)
Construction Fund Deposit	\$ 93,244,343	\$ 93,775,061	\$ 530,718
Total debt service payments	\$ 167,776,200	\$ 131,293,205	(\$ 36,482,995)
Overall bond interest rate	4.000%	2.520%	(1.480%)
Maximum underwriting discount	0.500%	0.136%	(0.364%)
Final maturity of the Bonds	30 years	20.5 years	(5 years)
Maximum total overall debt millage rate (all voted debt)	2.75 mills	2.75 mills	-

Robotics & STEAM



Planning

Robotics Relocation

- Field House Split
- Temporary Construction to House Program
- Student Occupied Facility
- School Construction Code Requirements
- Estimated Cost - \$429K

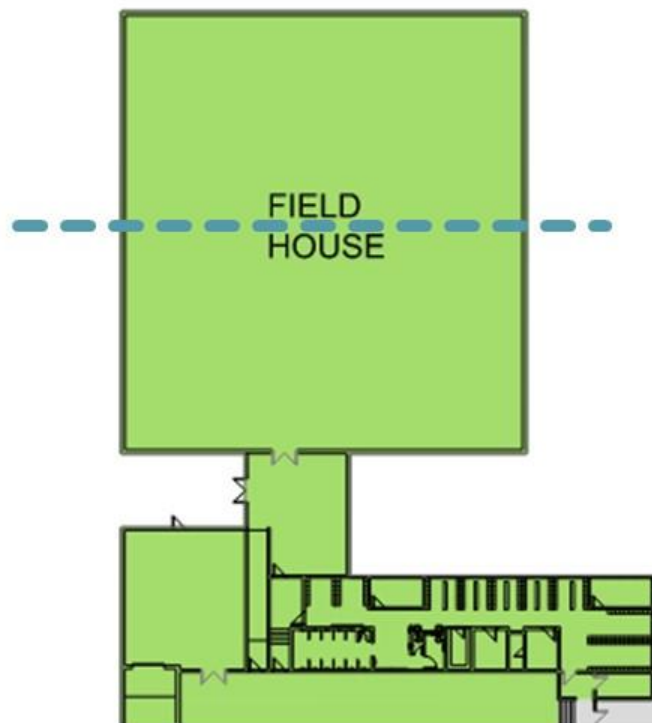



BHS Facility
2258 Franklin Road
Bloomfield Hills, MI 48302

- Lot Size: 1.00 acres (43,560 s.f.)
- Facility Size: 15,000 s.f.
- Limited Parking



281 Enterprise Court

Property Description

- Suite 100: 10,007 s.f.
- Private Entrance
- Ceiling Height = 16'-0"
- +/- 110 Parking Spaces
- (1) Overhead Door
- Listed Rent: \$8.95 per s.f. NNN
- Listed Sale Price: \$2,650,000 (entire facility)
- Facility Size: 30,607 s.f.





450-470 Enterprise Court

Property Description

- Facility Size: 23,398
 - Multiple Entrances
 - Ceiling Height = 12'-0"
 - +/- 95 Parking Spaces
 - Overhead Door
-
- Listed Sale Price: \$1,690,000
 - Listed Rent: \$10.50 per s.f.



plante moran CRESA
REAL ESTATE CONSULTANTS

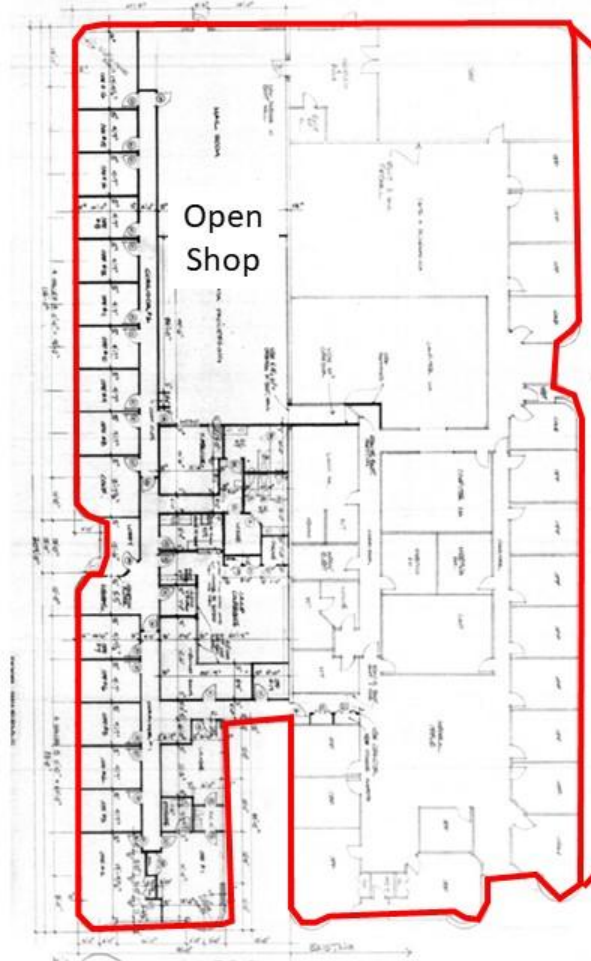

Planning *Forward*

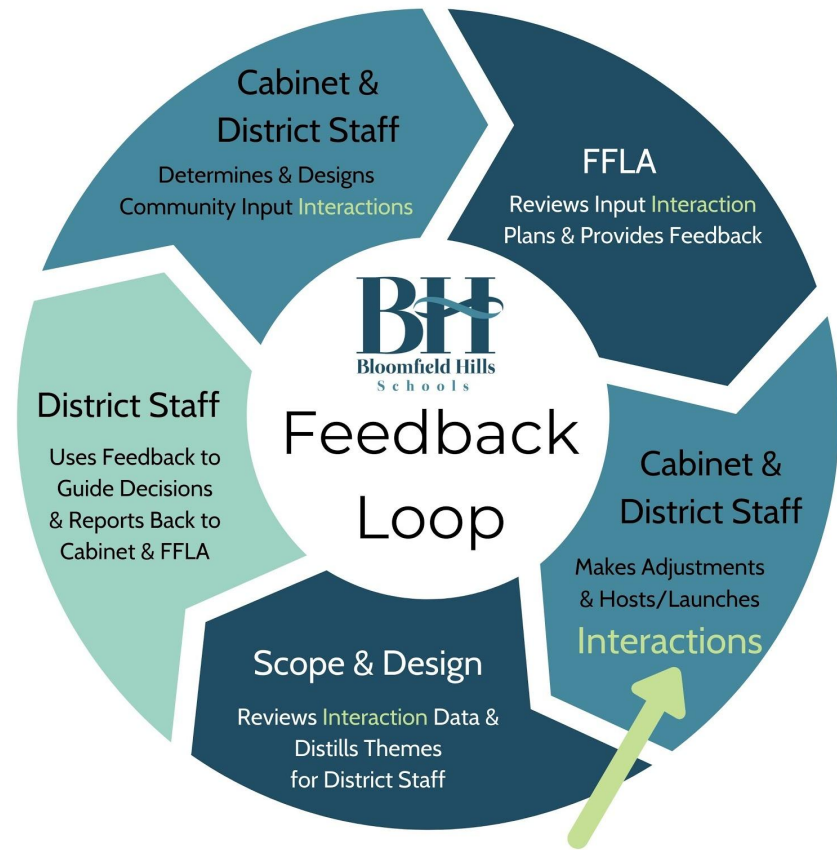

Community involvement in the form of:
Surveys
Focus Groups
Other Interactions



Middle School - Planning

Meeting Schedule

Description	Beginning In...
Mechanical + Electrical + Support	September
Site Planning	September
Leadership Team Areas + Office Space	October
Study Session	October
Physical Activity Areas + Community Areas	October
Middle School Teaming + Learning Communities	October
Study Session	November
Media Center + Entrepreneur Areas (STEM, Shop)	November
Performing + Visual Arts	November
Study Session	December
Healthy Lifestyles + The Arts	December
Special Education + Inclusive Designs	December
Scope + Design	January
Study Session	January
Board Meeting	January

Planning

Mechanical + Electrical + Support Spaces

- Operations Department Roundtable held in September
- Systems + Equipment Selection
- Multiple Manufacturer Led Site Visits

<div data-bbox="1058 292 1242 317"></div> <div data-bbox="1058 340 1226 358">MEP Meeting Minutes</div> <div data-bbox="1058 364 1309 410"><p>PROJECT: Bloomfield Hills Schools - 2020 Bond SES PROJECT NO: 2010019-13 DATE: 09/03/2020 SUBJECT: MEP System Discussion</p></div> <div data-bbox="1058 432 1101 444"><u>Attendees</u></div> <div data-bbox="1068 450 1203 580"><ol style="list-style-type: none">1. Nathan Stalker (SES)2. Rachel Stalker (SES)3. Ryan Coburn (SES)4. Paul Cornelissen (FA)5. Suzanne Carlson (FA)6. Daryl Dombrow (BMB)7. Bradley Kucak (BMB)8. Brian Jesse (BM Technology)9. Brian Gohy (BHS)10. Bruce Colman (BHS)11. Matt Lowe - (BHS HVAC)12. Chris Bille - (BHS HVAC)13. Dennis Harbeck - (BHS Elec)</div> <div data-bbox="1058 598 1143 610"><u>Mechanical Systems</u></div> <div data-bbox="1085 616 1460 874"><ol style="list-style-type: none">1. Preference for cooling is Chilled Water - SES would recommend an air cooled chiller because of system size and elimination of maintenance associated with a cooling tower2. Classrooms will have ducted VAV's with or without a ceiling in the rooms - BM to review possibility of pre-purchase for VAV's for the district.<ol style="list-style-type: none">a. District is comfortable with Araditeb. Daryl to set-up time for Change Air presentationc. Trans option is Tempco3. District has had good experience with Trane equipment, mixed with Daikin, and not good with York. Currently, the district has a York water cooled chiller at the high school, but no experience with an air cooled machine.<ol style="list-style-type: none">a. Some RTU sizes may limit control options - manufacturers controls with potential to integrate into BMSb. Mini-split system will have manufacturers controls with potential to integrate into BMS4. Automated Logic controls - Use CSQ or Metro Controls<ol style="list-style-type: none">a. Lochmar Crest - currently in districtb. PK Mach - currently in elementary schoolsc. Clever Brooks - only fire lubricant iron section experienced. Auro - no experience in district, but the district is open to seeing their product5. Currently the hot water portions of the systems at MS North have glycol. The piping on the roof needs to be further reviewed to determine if it can be re-used.7. The district would prefer heating hot water equipment to be hot water in lieu of gas fired as much as possible.8. Pumps</div>	<p>strict not.</p> <p>%, EWC's</p> <p>to sensor locations to specified sensor layouts issues in first year - lots of issues in district rectangle</p> <p>Signal to be basis of design. Gamewell to be excluded</p> <p>Issue with Generac: Generac and Square D are approved manufacturers. GE</p> <p>If were discussed. SES was originally looking to keep ation, this equipment is 60 years old and although it is to usable life cycle. SES recommends replacing local feeders. If the district decides to keep existing equipment to test existing equipment and document the existing ratings. Discussed. SES will send over information on future log control systems. Have (dimable LED troffers with a ceiling mounted</p> <p>to - SES will send over information on a basic keypad all as a more advanced lighting control solution. competitive spec for all lighting fixtures. If there are any directly by the owner and installed by the contractor.</p> <p>4000 West Eleven Mile Road Sterling, MI 48312 248.392.1300 www.sesentl.com</p> <p>SEP 2020 09:03 AM</p> <p>Page 2 of 2</p>
---	---

Planning

Site Planning

- Site Review Meetings Held in September & October
- Principal and Assistant Principal Review, Input and Modifications
- Safety + Traffic Flow
- ADA + Accessibility

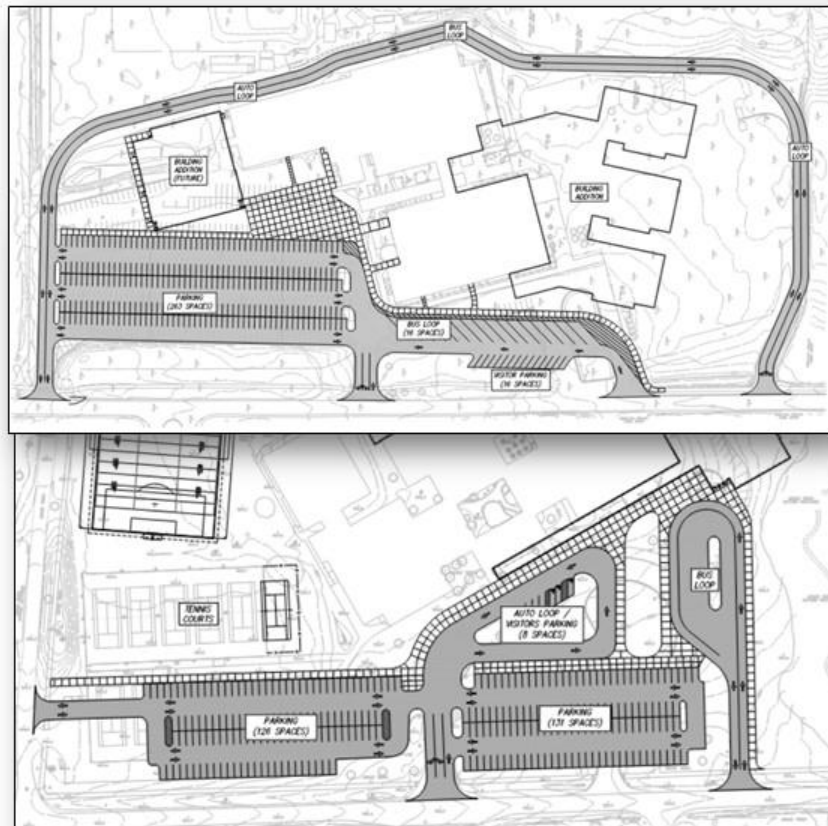

Planning

Lahser Selective Demo + Abatement

- Bid Package No. 1 – Lahser Demo
 - Demo Planning Underway
 - January Bid + Award Schedule
- Asbestos Abatement
 - December Bid + Award Schedule
 - Estimate

					Bloomfield Hills Schools 2020 Bond Program Master Schedule				Barton Malow	
ID	Task Name	Start	Finish	Duration	2020	H1	H2	2021	H1	H2
1	Abatement Schedule	Thu 8/20/20	Mon 3/1/21	138 days						
2	Project Kick-Off Meeting	Thu 8/20/20	Thu 8/20/20	0 days				8/20		
3	Abatement Meeting I	Thu 10/1/20	Thu 10/1/20	0 days				10/1		
4	Abatement Meeting II	Thu 10/15/20	Thu 10/15/20	0 days				10/15		
5	Bid Phase	Fri 10/16/20	Wed 12/2/20	34 days						
6	Award Rec to Owner	Thu 12/3/20	Thu 12/3/20	0 days				12/3		
7	Board of Education Award	Thu 12/17/20	Thu 12/17/20	0 days				12/17		
8	Abatement Phase	Mon 1/18/21	Mon 3/1/21	31 days						
9	Bid Package No. 1 - Lahser Demo Project									
10	Project Kick-Off Meeting	Thu 8/20/20	Thu 8/20/20	0 days				8/20		
11	Design Meeting I	Thu 9/3/20	Thu 9/3/20	0 days				9/3		
12	Design Meeting II	Tue 10/20/20	Tue 10/20/20	0 days				10/20		
13	Design Meeting III	Tue 11/3/20	Tue 11/3/20	0 days				11/3		
14	Bid Docs to Barton Malow	Tue 12/1/20	Tue 12/1/20	0 days				12/1		
15	Pre-Bid Meeting	Tue 12/8/20	Tue 12/8/20	0 days				12/8		
16	Addendum	Mon 12/14/20	Mon 12/14/20	0 days				12/14		
17	Bids Due	Thu 12/17/20	Thu 12/17/20	0 days				12/17		
18	Post Bid Interviews	Fri 12/18/20	Fri 1/1/21	11 days						
19	Award Rec to Owner	Thu 1/7/21	Thu 1/7/21	0 days				1/7		
20	Board of Education Award	Thu 1/14/21	Thu 1/14/21	0 days				1/14		
21	Demo Phase	Mon 3/1/21	Fri 5/21/21	60 days						

PRELIMINARY FOR DISCUSSION PURPOSES

- Technology Kick-Off Meeting – August
 - Systems Review
 - Selection Process
 - Procurement Strategy
- Classroom Technology Kick-Off Meeting – October
 - Pilot Teams
 - Criteria



END OF SECTION

DISCUSSION